

LOCATION MAP  
Source: N.Y.S.D.O.T. Quadrangle Sheet - Oneonta, NY

"Copies from the original of this survey map not marked with an original of the land surveyor's inked seal or embossed seal shall not be considered to be a valid true copy."

Alterations not conforming to section 7209, subdivision 2, of the State Education Law, are prohibited.

LEGEND	
COUNTY TAX PARCEL LINE	---
STREET CENTERLINE	---
WATER	---
SANITARY	---
STORM	---
GAS	---
UNDERGROUND COMMUNICATION	---
CATCH BASIN	ⓓ
SANITARY MANHOLE	Ⓢ
STORM MANHOLE	Ⓜ
WATER VALVE	Ⓜ
WATER SHUT-OFF	Ⓜ
HYDRANT	Ⓜ
UTILITY POLE	Ⓜ
GUY WIRE	Ⓜ
GAS VALVE	Ⓜ
SINGLE POLE SIGN	Ⓜ

- NOTES**
- Underground facilities, structures and utilities have been located from available records, field locations of associated above ground structures, and any markings provided by the client. Therefore, these locations must be considered approximate. There may be other underground utilities and/or structures, the location and existence of which is not presently known. Location of underground facilities, utilities and structures are not certified.
  - Call Dig Safely New York 1-800-962-7962 before digging, drilling or blasting.
  - Vertical Datum: NAVD 88 GPS Network Derived.
  - Contour Interval: 1 foot.
  - Horizontal Datum is rigidly adjusted to the New York State Plane Coordinate System, East Zone.
  - In the event that there is a discrepancy between the contents of the signed and sealed hardcopy drawing and the corresponding digital drawing file, the hardcopy with an original stamp and signature shall be the controlling document. Be sure to compare the two documents before using the digital file.
  - No Boundary Survey was Performed. Street Right of Way and Tax Parcel Lines are shown per Otsego County GIS Mapping and are to be considered Approximate.

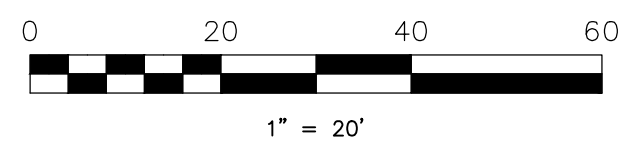
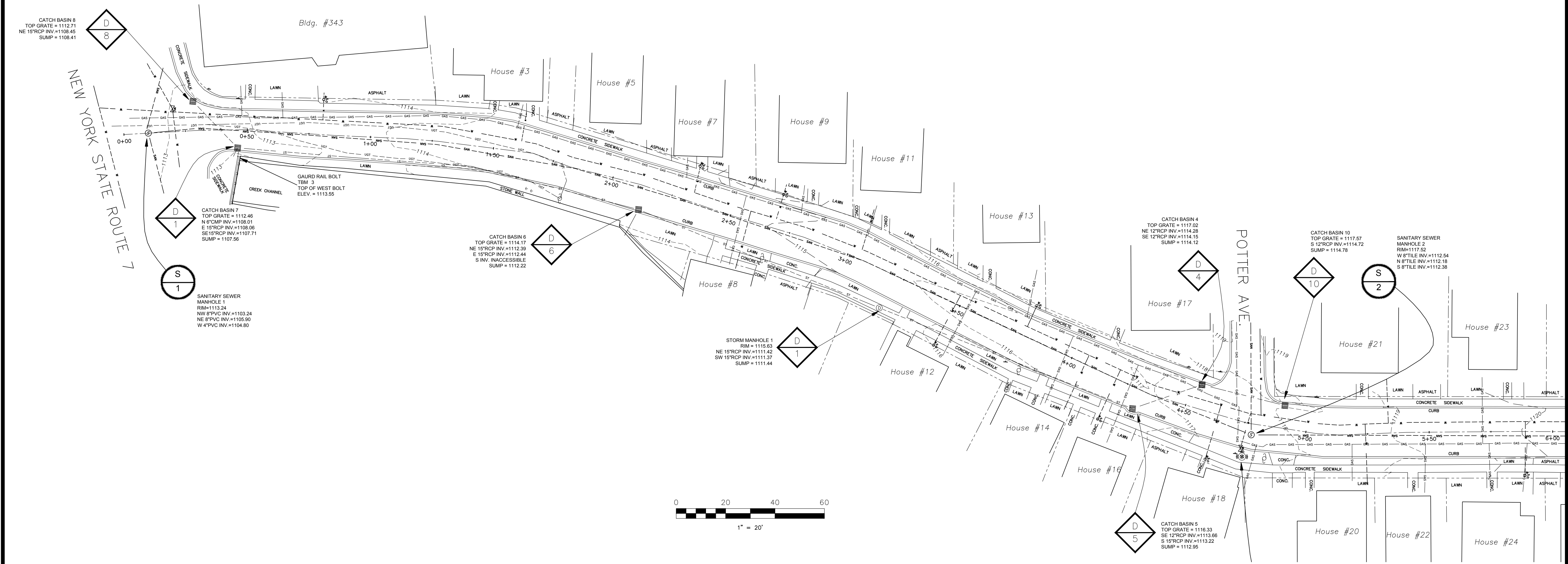

**Pine Street**  
Plan View  
Station 0+00 - 5+50  
City of Oneonta, County of Otsego  
State of New York

REVISIONS

No.	Date	Description

**LAWSON SURVEYING & MAPPING**

Boundary ~ Topographic ~ Control ~ Deformation ~ Construction ~ C.I.S. ~ Subdivision ~ G.P.S.  
2095 County Route 8, Oneonta, New York 13820  
Phone: (607) 432-3300  
Facsimile: (607) 432-3613  
www.lawsonsurvey.com

Robert J. Lawson, L.S.  
N.Y.S. License No. 050086

DATE: June 6, 2018  
W.O. No.: 6076  
SCALE: AS NOTED  
DRAWN BY: J.D.J.  
CHECKED BY: R.J.L.  
FIELD CHECKED BY: J.E.W.  
DWG FILE: 6076.DWG  
MAP No.: M 24-1005  
SHEET No.: 1 of 5