

NOTES

- Underground facilities, structures and utilities have been located from available records, field locations of associated above ground structures, and any markings provided by the client. Therefore, these locations must be considered approximate. There may be other underground utilities and/or structures, the location and existence of which is not presently known. Location of underground facilities, utilities and structures are not certified.
- Call Dig Safely New York 1-800-962-7962 before digging, drilling or blasting.
- Vertical Datum: NAVD 88 GPS Network Derived.
- In the event that there is a discrepancy between the contents of the signed and sealed hardcopy drawing and the corresponding digital drawing file, the hardcopy with an original stamp and signature shall be the controlling document. Be sure to compare the two documents before using the digital file.

"Copies from the original of this survey map not marked with an original of the land surveyor's raised seal or embossed seal shall not be considered to be a valid true copy."
 Alterations not conforming to section 7209, subdivision 2, of the State Education Law, are prohibited.

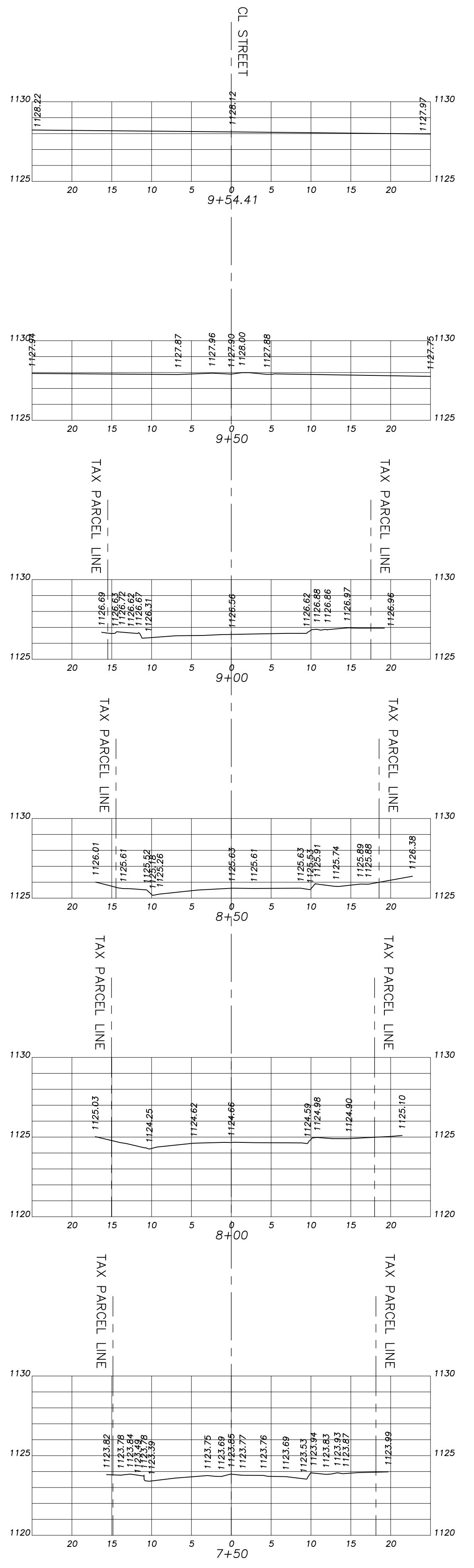
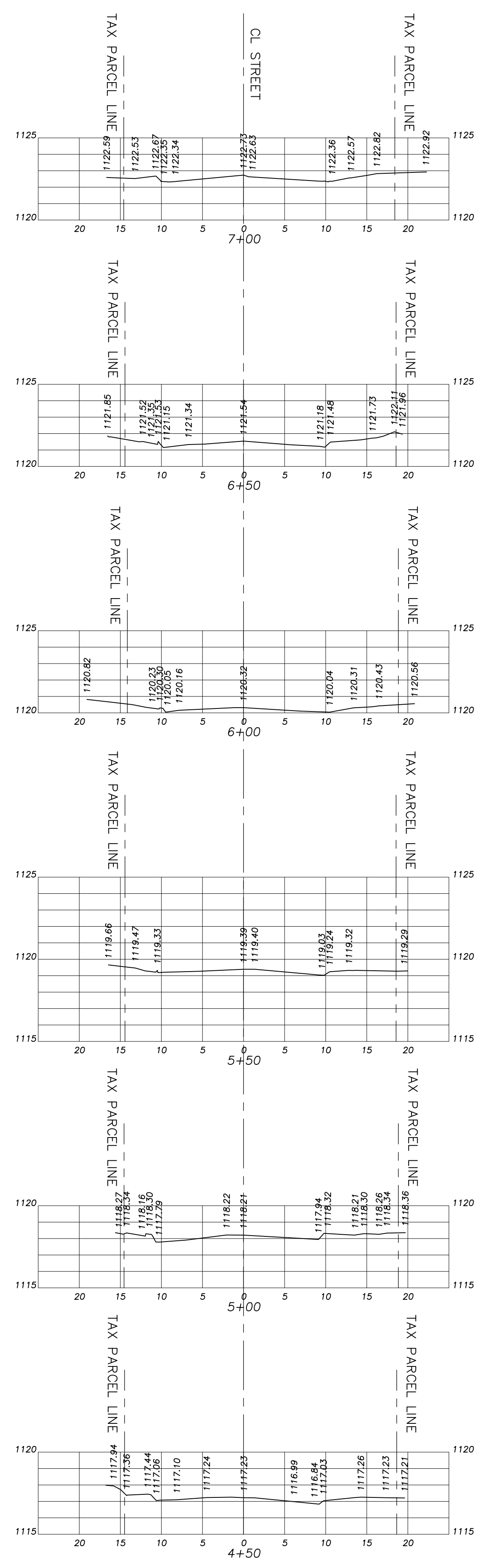
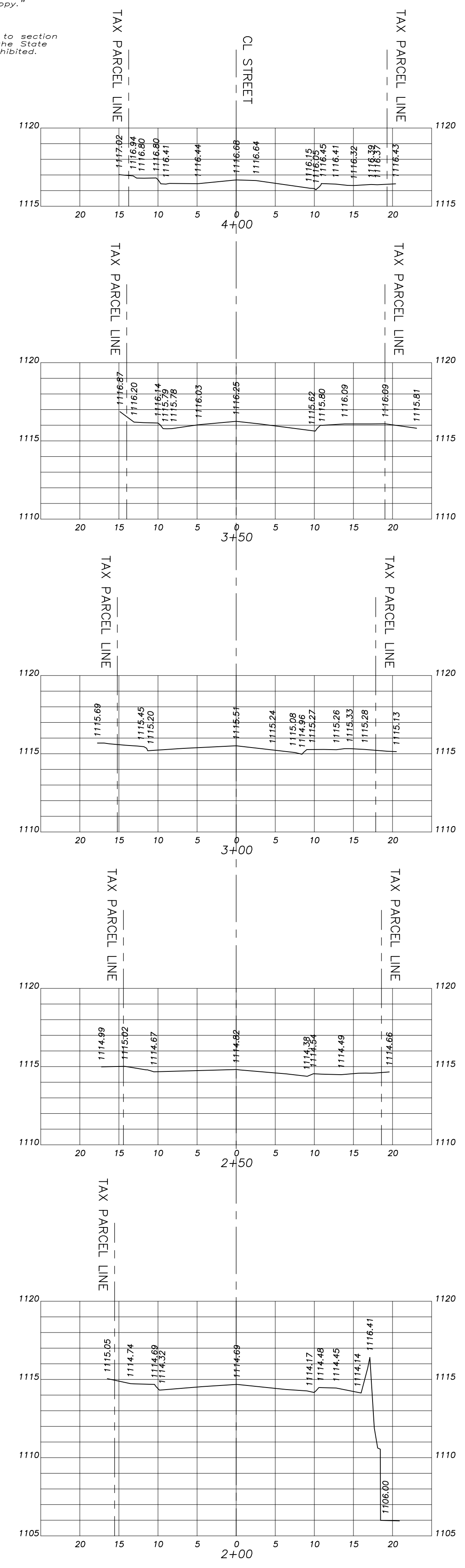
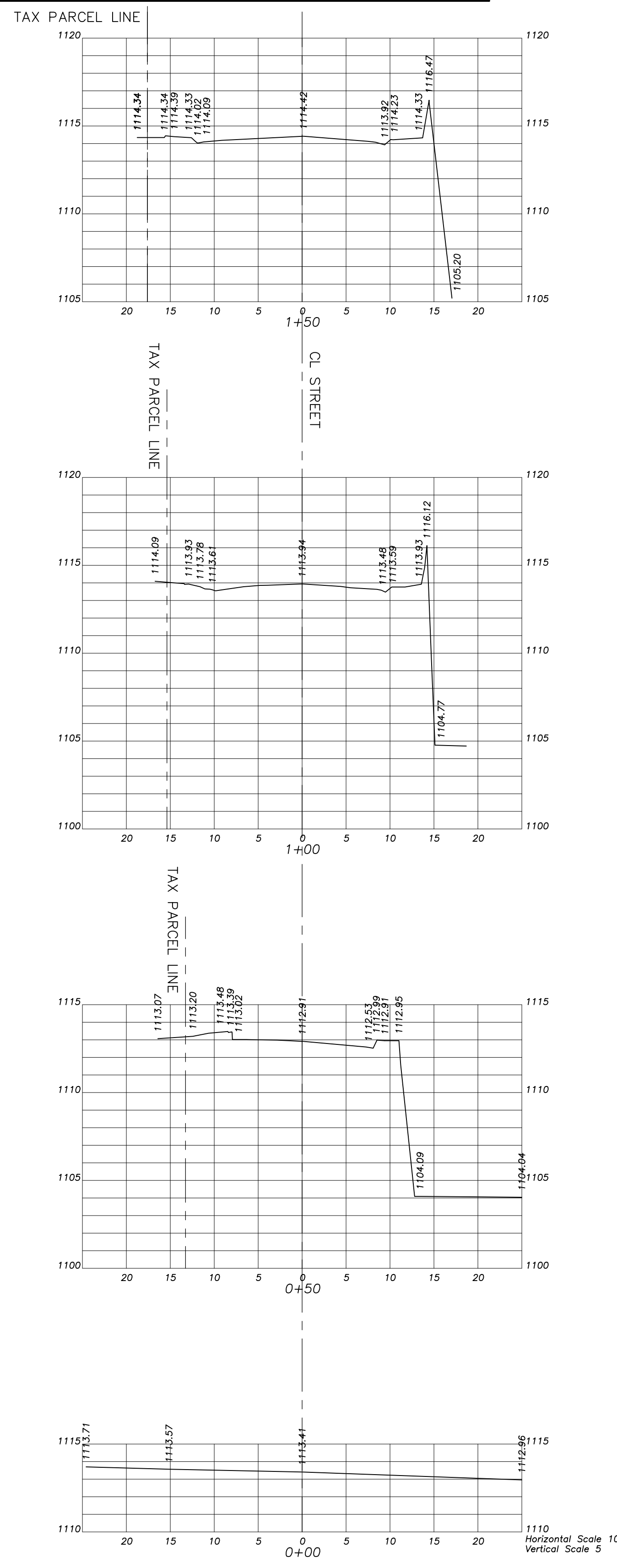

Pine Street
 Street Cross Sections
 0+00 - 9+54.41
 City of Oneonta, County of Otsego
 State of New York

No.	Date	Description

LAWSON SURVEYING & MAPPING
 Boundary ~ Topographic ~ Control ~ Deformation ~ Construction ~ C.I.S. ~ Subdivision ~ G.P.S.
 2958 County Route 8 • Oneonta, New York 13820
 Phone: (807) 432-3300
 Facsimile: (807) 432-3013
 www.lawsonsurvey.com

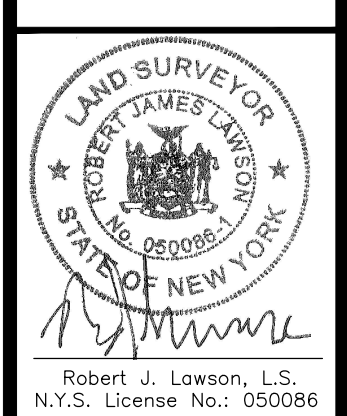
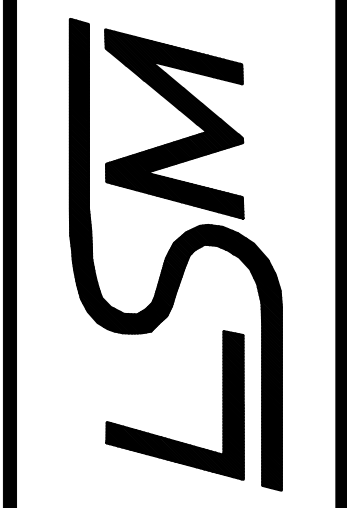

DATE: June 6, 2018
W.O. No.: 6076
SCALE: AS NOTED
DRAWN BY: J.D.J.
CHECKED BY: R.J.L.
FIELD CHECKED BY: J.E.W.
DWG FILE: 6076.DWG
MAP No.: M 24-1005
SHEET No.: 4 of 5